

MAP PREPARED BY
 TEXAS DEPARTMENT OF WATER RESOURCES
 INDEX MAP OF MOSAIC SECTIONS
 FOR CERTIFICATES OF ADJUDICATION ISSUED
 IN THE UPPER LEON RIVER SEGMENT
 BRAZOS RIVER BASIN

LEGEND

- TOP-MAP COVERAGE
- LIMIT OF INVESTIGATION
- COUNTY LINE
- EXTENT OF AERIAL PHOTO MOSAICS

SCALE OF MAP
 0 5 10 20 MILES

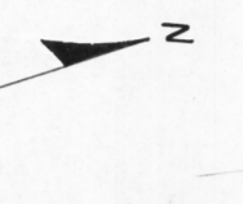

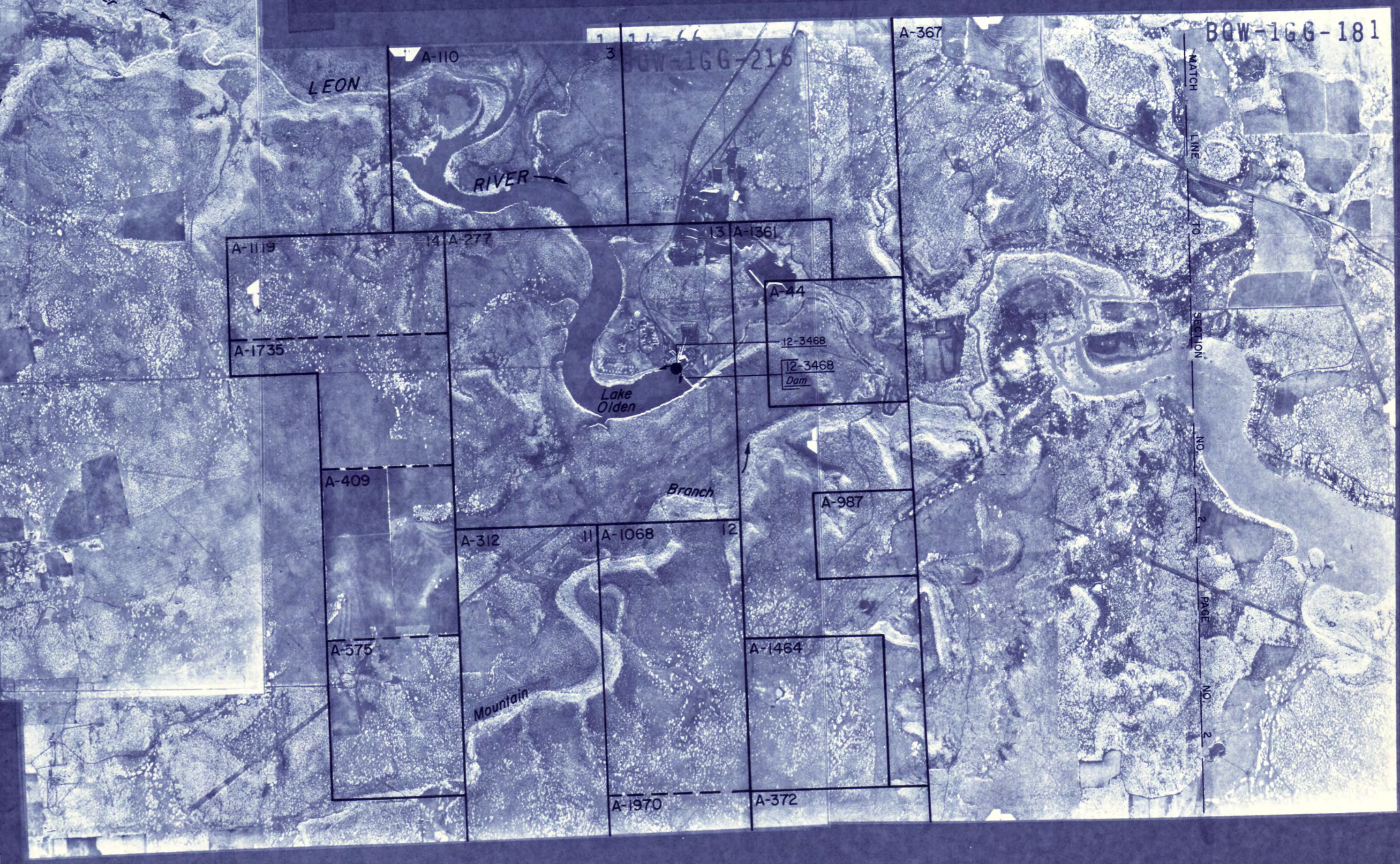
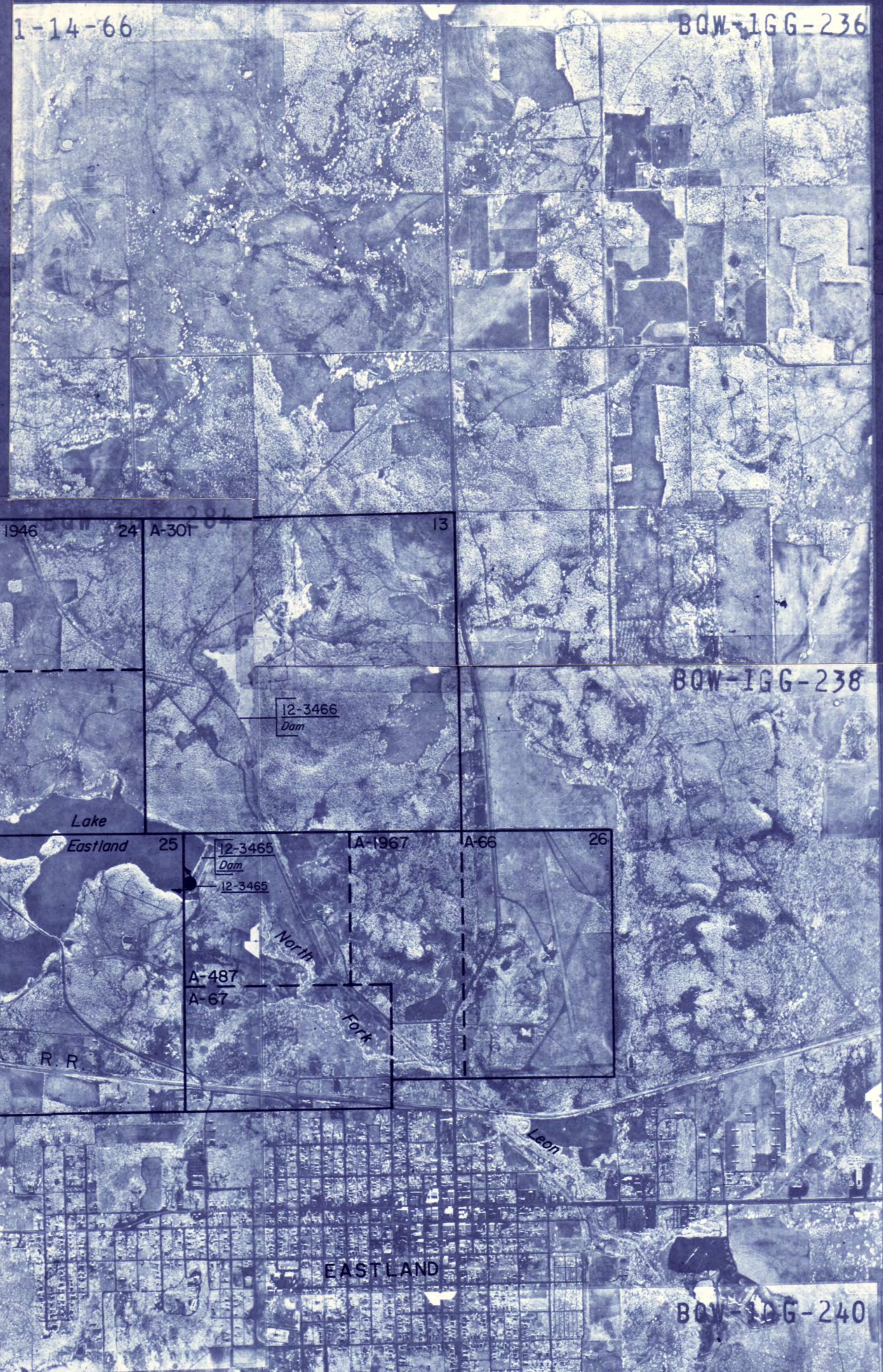
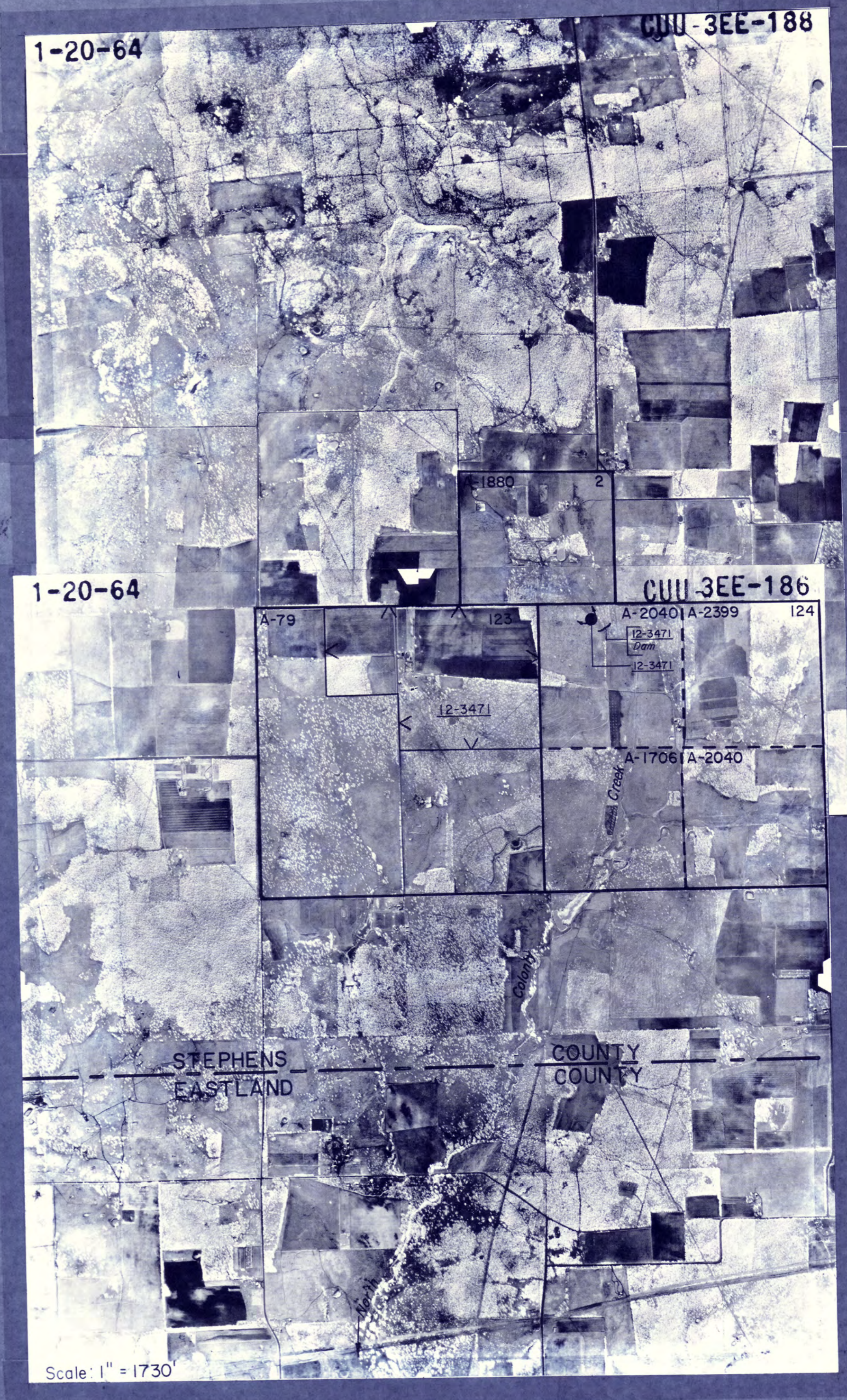
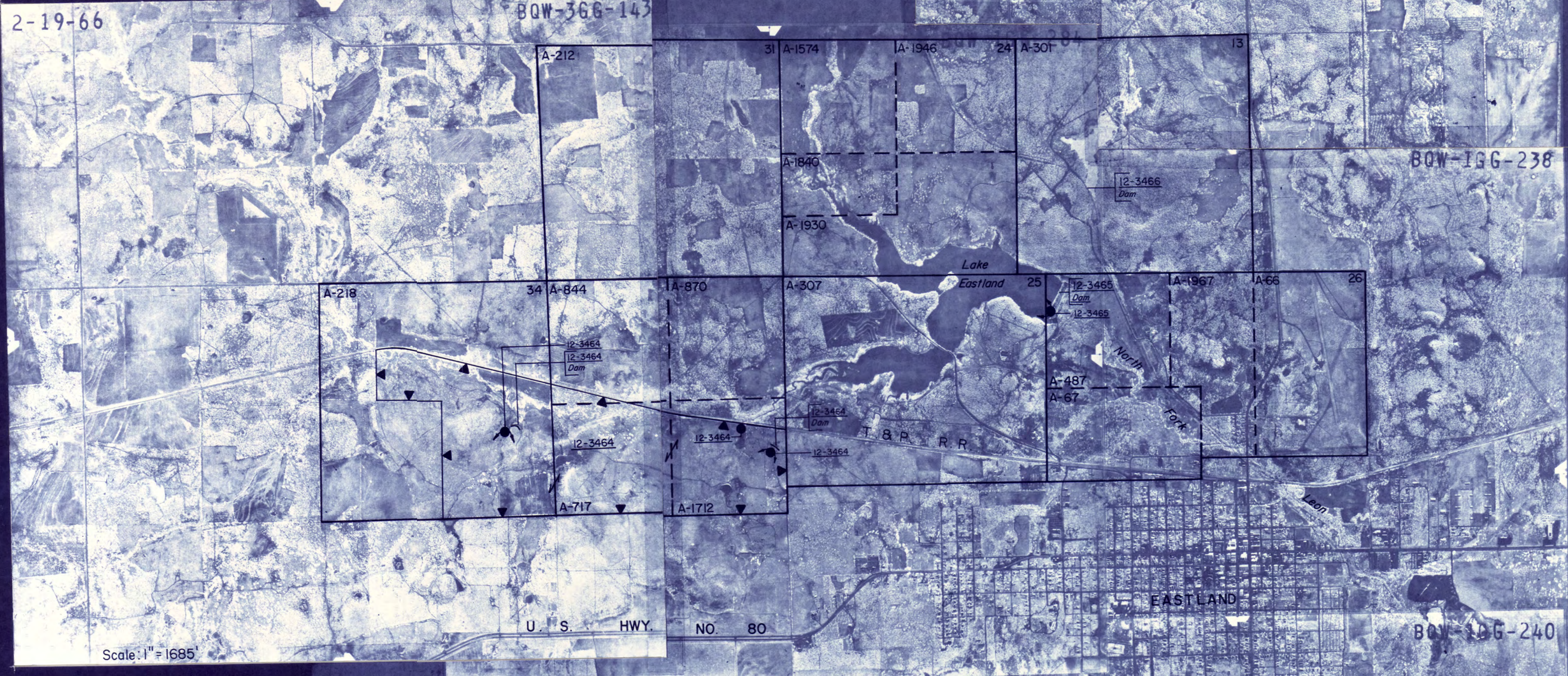

TEXAS WATER COMMISSION
UPPER LEON RIVER SEGMENT
CERTIFICATES OF ADJUDICATION MAP *

REFLECTING THE CERTIFICATES OF ADJUDICATION ISSUED IN THE UPPER LEON RIVER SEGMENT OF THE BRAZOS RIVER BASIN IN ACCORDANCE WITH FINAL DECREE OF THE 35TH JUDICIAL DISTRICT COURT OF MILLS COUNTY, TEXAS, IN CAUSE NO. 4097, IN RE: THE ADJUDICATION OF WATER RIGHTS IN THE UPPER LEON RIVER SEGMENT OF THE BRAZOS RIVER BASIN ON THE 8TH DAY OF SEPTEMBER, 1983.

* NOTE: ORIGINAL SURVEY LOCATIONS AS SHOWN ON PHOTO MOSAIC, AND ANY REFERENCE THERETO, SHOULD BE CONSIDERED AS APPROXIMATE AND SHOULD NOT BE RELIED UPON FOR LAND TRANSACTIONS.

AERIAL PHOTO MOSAICS
LEGEND

- Symbols:
- Authorized diversion from a specific point on a stream and/or reservoir.
 - Authorized diversion from any point on the perimeter of a reservoir.
 - Authorized diversion is from any place along stream between these points.
 - Ownership boundaries where not coincident with certificate of adjudication boundaries.
 - Landhooks connect lands of one ownership.
 - [A to S] Abstract and survey numbers of original survey and boundary line.
 - ▲ Various symbols used to denote limits of certificates of adjudication.

Abbreviations:
12-3500 Certificate of adjudication number.
Dam On channel dam authorized by certificate of adjudication.
Res Off channel reservoir authorized by certificate of adjudication.



EASTLAND COUNTY
1966 A.S.C.S. PHOTOS
SECTION 1 OF 6
Scale: 1" = 1705' Approx.

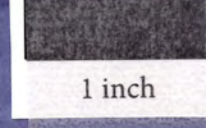

Missing Map Scan Page Epson7262

(The sequence of maps provided is missing this page #)

Missing Map Scan Page Epson7263

(The sequence of maps provided is missing this page #)

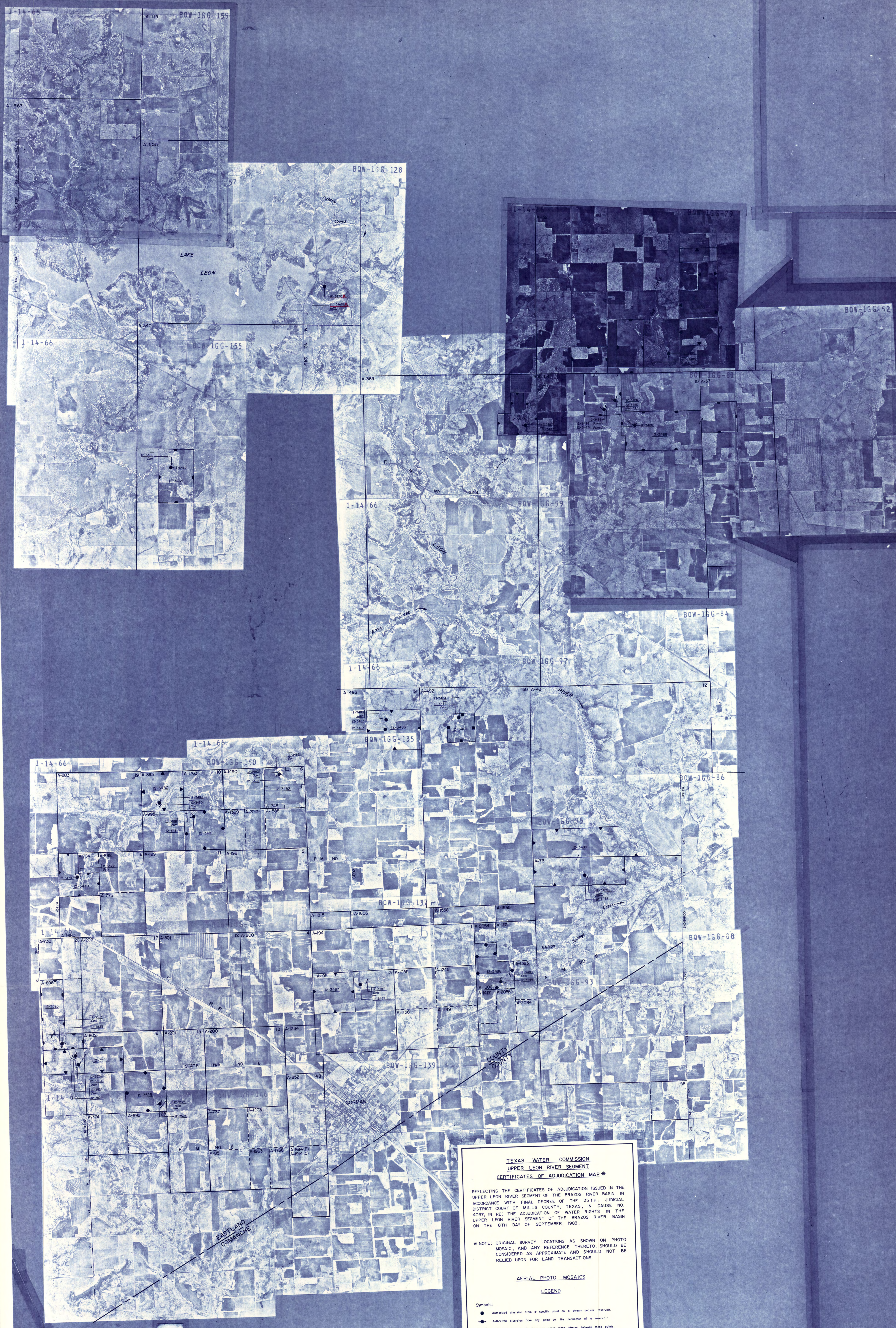

EASTLAND COUNTY
 1966 A.S.C.S PHOTOS
 SECTION 2 OF 6
 Scale 1" = 1700' Approx.

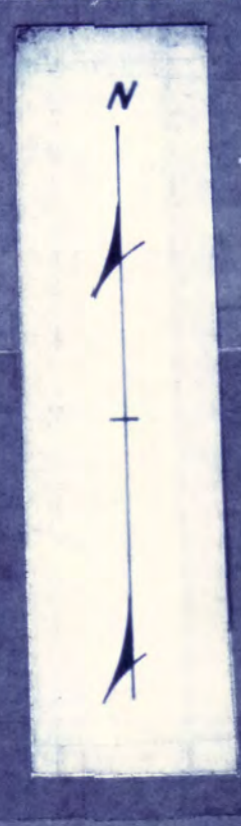

TEXAS WATER COMMISSION
 UPPER LEON RIVER SEGMENT
 CERTIFICATES OF ADJUDICATION MAP *

REFLECTING THE CERTIFICATES OF ADJUDICATION ISSUED IN THE UPPER LEON RIVER SEGMENT OF THE BRAZOS RIVER BASIN IN ACCORDANCE WITH FINAL DECREE OF THE 35TH JUDICIAL DISTRICT COURT OF MILLS COUNTY, TEXAS, IN CAUSE NO. 4097, IN RE: THE ADJUDICATION OF WATER RIGHTS IN THE UPPER LEON RIVER SEGMENT OF THE BRAZOS RIVER BASIN ON THE 8TH DAY OF SEPTEMBER, 1983.

* NOTE: ORIGINAL SURVEY LOCATIONS AS SHOWN ON PHOTO MOSAIC, AND ANY REFERENCE THERETO, SHOULD BE CONSIDERED AS APPROXIMATE AND SHOULD NOT BE RELIED UPON FOR LAND TRANSACTIONS.

AERIAL PHOTO MOSAICS
 LEGEND

Symbols:

- Authorized diversion from a specific point on a stream and/or reservoir.
- Authorized diversion from any point on the perimeter of a reservoir.
- Authorized diversion is from any place along stream between these points.
- Ownership boundaries where not coincident with certificate of adjudication boundaries.
- Landowners connect lands of one ownership.
- [A-175] Abstract and survey numbers of original survey and boundary line.

Various symbols used to denote limits of certificates of adjudication.

Abbreviations:

- BQW Certificate of adjudication number.
- 12-3555 On channel reservoir authorized by certificate of adjudication.
- 12-3555 On channel reservoir authorized by certificate of adjudication.

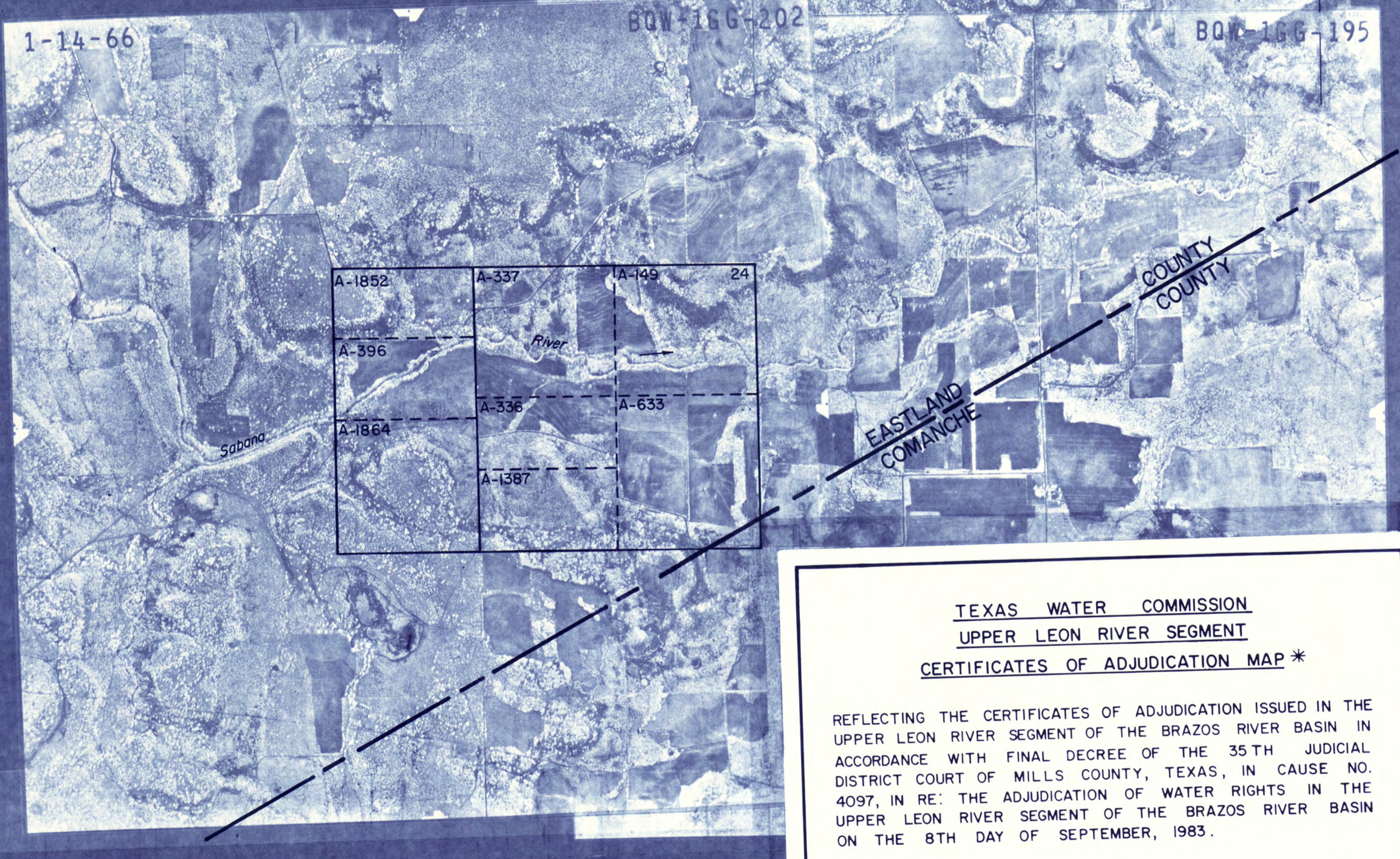
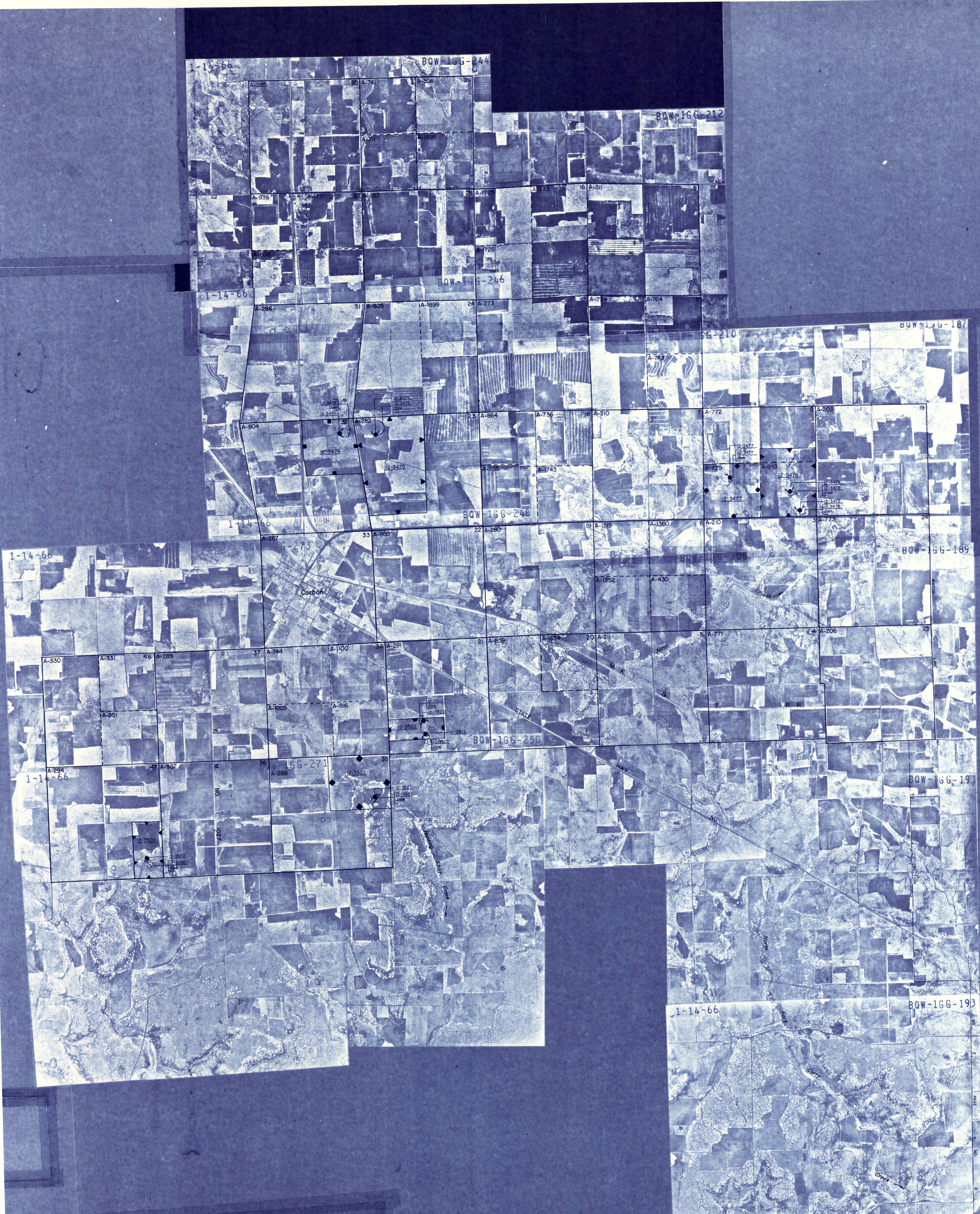

EASTLAND COUNTY
1966 A.S.C.S. PHOTOS
SECTION 4 OF 6
Scale 1" = 1670' Approx

EASTLAND COUNTY
1966 A.S.C.S. PHOTOS
SECTION 3 OF 6
Scale 1" = 1695' Approx

TEXAS WATER COMMISSION
UPPER LEON RIVER SEGMENT
CERTIFICATES OF ADJUDICATION MAP *

REFLECTING THE CERTIFICATES OF ADJUDICATION ISSUED IN THE UPPER LEON RIVER SEGMENT OF THE BRAZOS RIVER BASIN IN ACCORDANCE WITH FINAL DECREE OF THE 35TH JUDICIAL DISTRICT COURT OF MILLS COUNTY, TEXAS, IN CAUSE NO. 4097, IN RE: THE ADJUDICATION OF WATER RIGHTS IN THE UPPER LEON RIVER SEGMENT OF THE BRAZOS RIVER BASIN ON THE 8TH DAY OF SEPTEMBER, 1983.

* NOTE: ORIGINAL SURVEY LOCATIONS AS SHOWN ON PHOTO MOSAIC, AND ANY REFERENCE THERETO, SHOULD BE CONSIDERED AS APPROXIMATE AND SHOULD NOT BE RELIED UPON FOR LAND TRANSACTIONS.

AERIAL PHOTO MOSAICS

LEGEND

Symbols:

- Authorized diversion from a specific point on a stream and/or reservoir.
- Authorized diversion from any point on the perimeter of a reservoir.
- Authorized diversion is from any place along stream between these points.
- Ownership boundaries where not coincident with certificate of adjudication boundaries.
- Landmarks connect lands of one ownership.
- Abstract and survey numbers of original survey and boundary line.

Various symbols used to denote limits of certificates of adjudication.

Abbreviations:

- 12-3500 Certificate of adjudication number.
- On channel dam authorized by certificate of adjudication.
- Off channel reservoir authorized by certificate of adjudication.

Missing Map Scan Page Epson7266

(The sequence of maps provided is missing this page #)

Missing Map Scan Page Epson7267

(The sequence of maps provided is missing this page #)

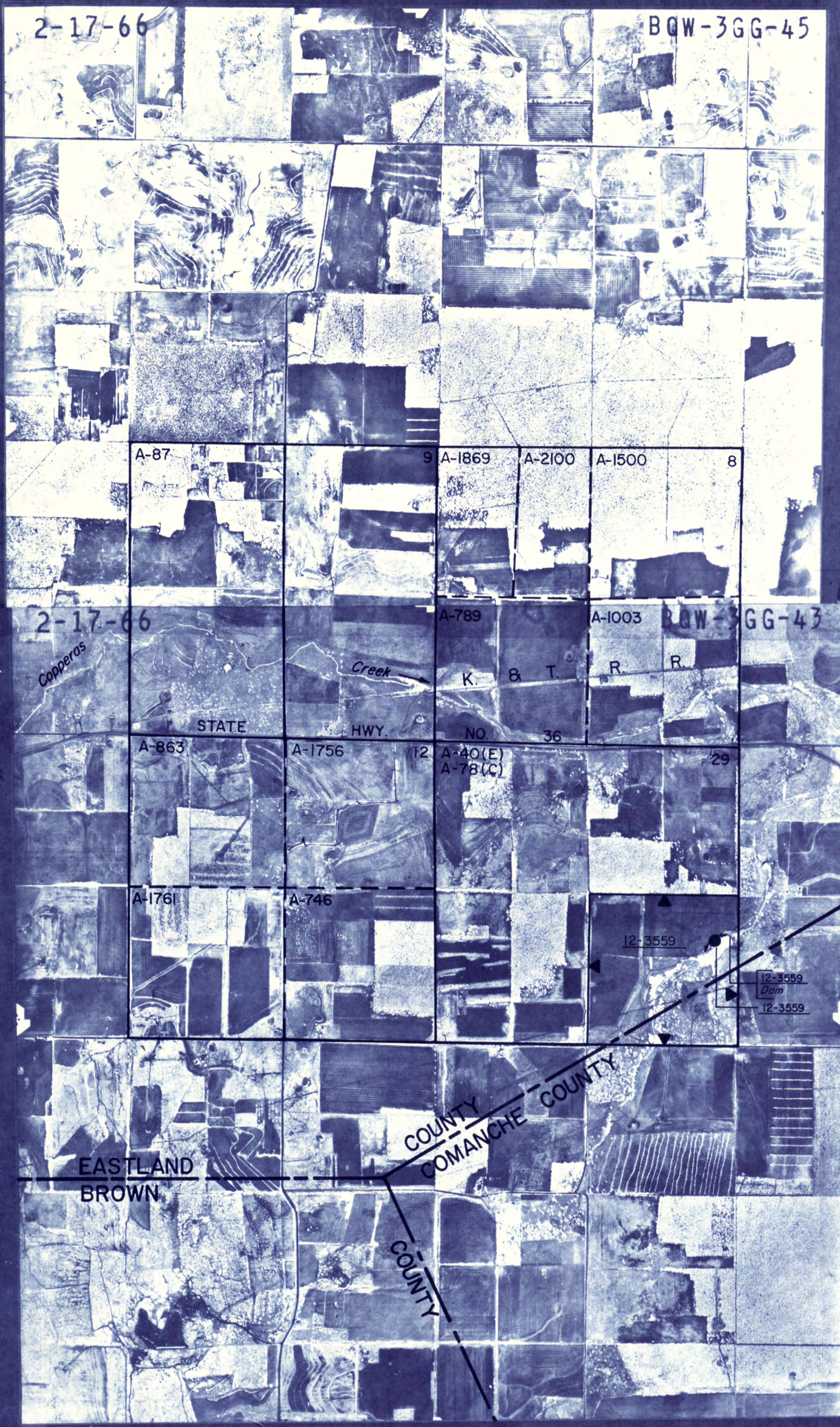

EASTLAND COUNTY
1966 ASCS PHOTOS
SECTION 6 OF 6
Scale 1"=1680' Approx.

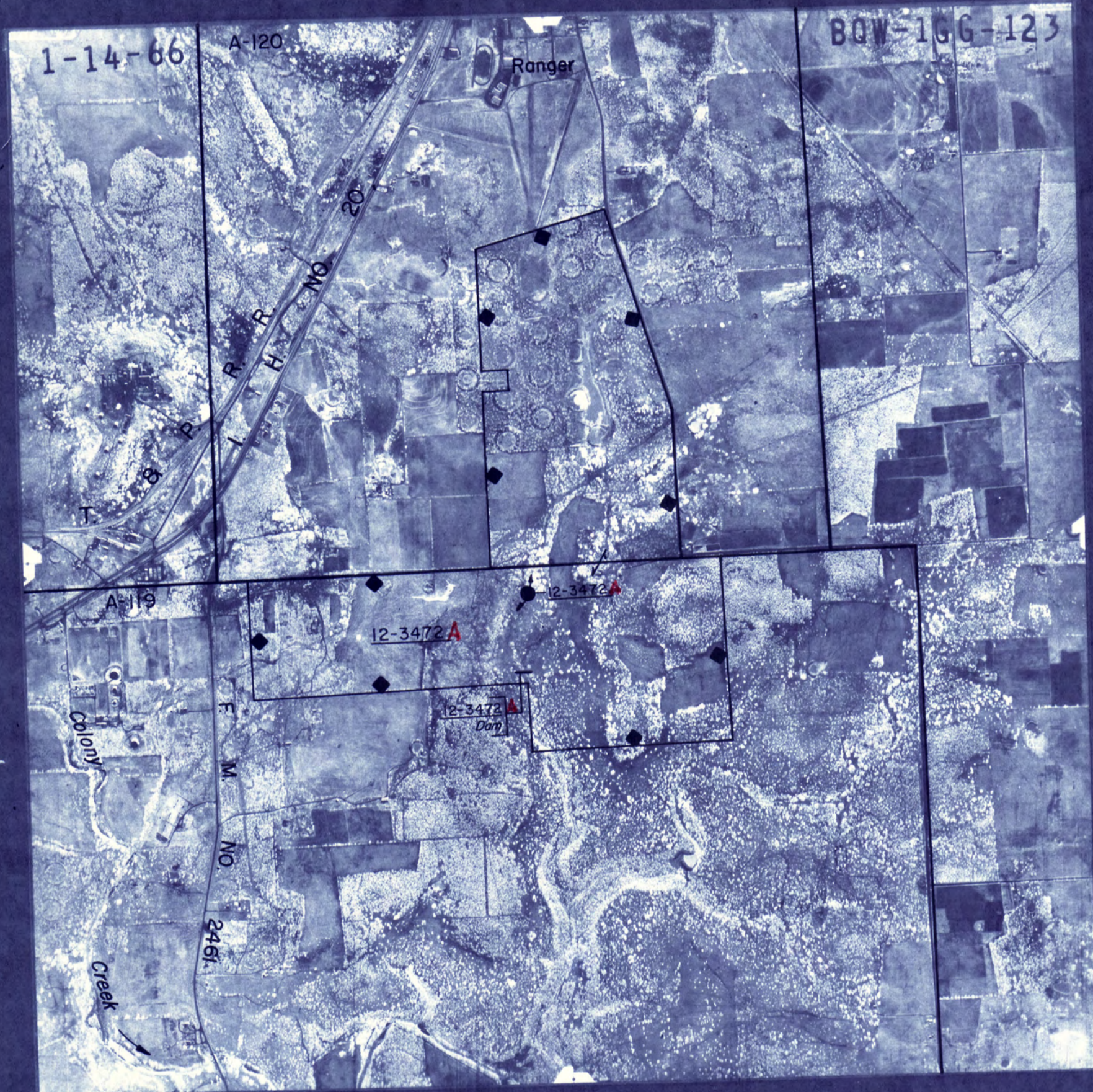
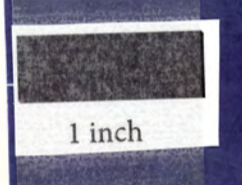

EASTLAND COUNTY
1966 ASCS PHOTOS
SECTION 5 OF 6
Scale 1"=1640' Approx.

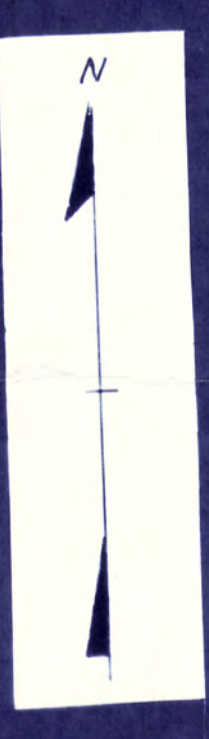
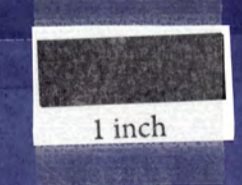

TEXAS WATER COMMISSION
UPPER LEON RIVER SEGMENT
CERTIFICATES OF ADJUDICATION MAP *

REFLECTING THE CERTIFICATES OF ADJUDICATION ISSUED IN THE UPPER LEON RIVER SEGMENT OF THE BRAZOS RIVER BASIN IN ACCORDANCE WITH FINAL DECREE OF THE 35TH JUDICIAL DISTRICT COURT OF MILLS COUNTY, TEXAS, IN CAUSE NO. 4037, IN RE: THE ADJUDICATION OF WATER RIGHTS IN THE UPPER LEON RIVER SEGMENT OF THE BRAZOS RIVER BASIN ON THE 8TH DAY OF SEPTEMBER, 1983.

* NOTE: ORIGINAL SURVEY LOCATIONS AS SHOWN ON PHOTO MOSAIC, AND ANY REFERENCE THERETO, SHOULD BE CONSIDERED AS APPROXIMATE AND SHOULD NOT BE RELIED UPON FOR LAND TRANSACTIONS.

AERIAL PHOTO MOSAICS

LEGEND

Symbols:

- Authorized diversion from a specific point on a stream and/or reservoir.
- Authorized diversion from any point on the perimeter of a reservoir.
- Authorized diversion is from any place along stream between these points.
- Ownership boundaries where not coincident with certificate of adjudication boundaries.
- Landmarks connect lands of one ownership.
- [A-103] Abstract and survey numbers of original survey and boundary line.
- ▼ Various symbols used to denote limits of certificates of adjudication.

Abbreviations:

- 12-3500 Certificate of adjudication number.
- Dem On channel dam authorized by certificate of adjudication.
- Res Off channel reservoir authorized by certificate of adjudication.

Missing Map Scan Page Epson7269

(The sequence of maps provided is missing this page #)

Missing Map Scan Page Epson7270

(The sequence of maps provided is missing this page #)

TEXAS WATER COMMISSION
 UPPER LEON RIVER SEGMENT
 CERTIFICATES OF ADJUDICATION MAP *

REFLECTING THE CERTIFICATES OF ADJUDICATION ISSUED IN THE UPPER LEON RIVER SEGMENT OF THE BRAZOS RIVER BASIN IN ACCORDANCE WITH FINAL DECREE OF THE 35TH JUDICIAL DISTRICT COURT OF MILLS COUNTY, TEXAS, IN CAUSE NO. 4097, IN RE: THE ADJUDICATION OF WATER RIGHTS IN THE UPPER LEON RIVER SEGMENT OF THE BRAZOS RIVER BASIN ON THE 8TH DAY OF SEPTEMBER, 1983.

* NOTE: ORIGINAL SURVEY LOCATIONS AS SHOWN ON PHOTO MOSAIC, AND ANY REFERENCE THERETO, SHOULD BE CONSIDERED AS APPROXIMATE AND SHOULD NOT BE RELIED UPON FOR LAND TRANSACTIONS.

AERIAL PHOTO MOSAICS

LEGEND

Symbols:

- Authorized diversion from a specific point on a stream and/or reservoir.
- Authorized diversion from any point on the perimeter of a reservoir.
- Authorized diversion is from any place along stream between these points.
- Ownership boundaries where not coincident with certificate of adjudication boundaries.
- Landmarks connect lands of one ownership.
- [A10 S] Abstract and survey numbers of original survey and boundary line.

- ▬ Various symbols used to denote limits of certificates of adjudication.

Abbreviations:

- 12-3500 Certificate of adjudication number.
- dam On channel dam authorized by certificate of adjudication.
- off Off channel reservoir authorized by certificate of adjudication.

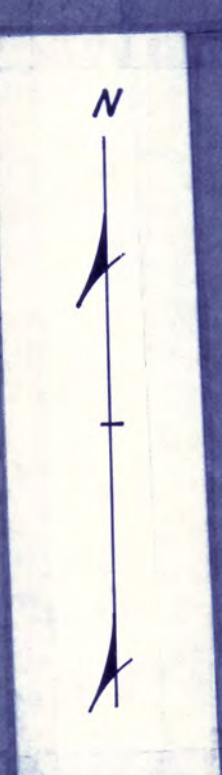

COMANCHE COUNTY
 1972 A.S.C.S. PHOTOS
 SECTION 1 OF 8
 Scale 1" = 1720' Approx

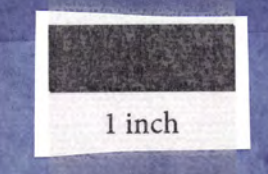

Missing Map Scan Page Epson7272

(The sequence of maps provided is missing this page #)

Missing Map Scan Page Epson7274

(The sequence of maps provided is missing this page #)



COMANCHE COUNTY
 1972 A.S.C.S. PHOTOS
 SECTION 3 OF 8
 Scale 1" = 1715' Approx.
 REDRAWN BY [unclear] 8 SEPT. 83

TEXAS WATER COMMISSION
UPPER LEON RIVER SEGMENT
CERTIFICATES OF ADJUDICATION MAP *

REFLECTING THE CERTIFICATES OF ADJUDICATION ISSUED IN THE UPPER LEON RIVER SEGMENT OF THE BRAZOS RIVER BASIN IN ACCORDANCE WITH FINAL DECREE OF THE 35TH JUDICIAL DISTRICT COURT OF MILLS COUNTY, TEXAS, IN CAUSE NO. 4097, IN RE: THE ADJUDICATION OF WATER RIGHTS IN THE UPPER LEON RIVER SEGMENT OF THE BRAZOS RIVER BASIN ON THE 8TH DAY OF SEPTEMBER, 1983.

* NOTE: ORIGINAL SURVEY LOCATIONS AS SHOWN ON PHOTO MOSAIC, AND ANY REFERENCE THERETO, SHOULD BE CONSIDERED AS APPROXIMATE AND SHOULD NOT BE RELIED UPON FOR LAND TRANSACTIONS.

AERIAL PHOTO MOSAICS
LEGEND

Symbols:

- Authorized diversion from a specific point on a stream and/or reservoir.
- Authorized diversion from any point on the perimeter of a reservoir.
- Authorized diversion from any place along stream between these points.
- Ownership boundaries where not coincident with certificate of adjudication boundaries.
- Landmarks connect lands of one ownership.
- Abstract and survey numbers of original survey and boundary line.
- Various symbols used to denote limits of certificates of adjudication.

Abbreviations:

- IR-3500 Certificate of adjudication number.
- DM On channel dam authorized by certificate of adjudication.
- OR On channel reservoir authorized by certificate of adjudication.

Missing Map Scan Page Epson7276

(The sequence of maps provided is missing this page #)

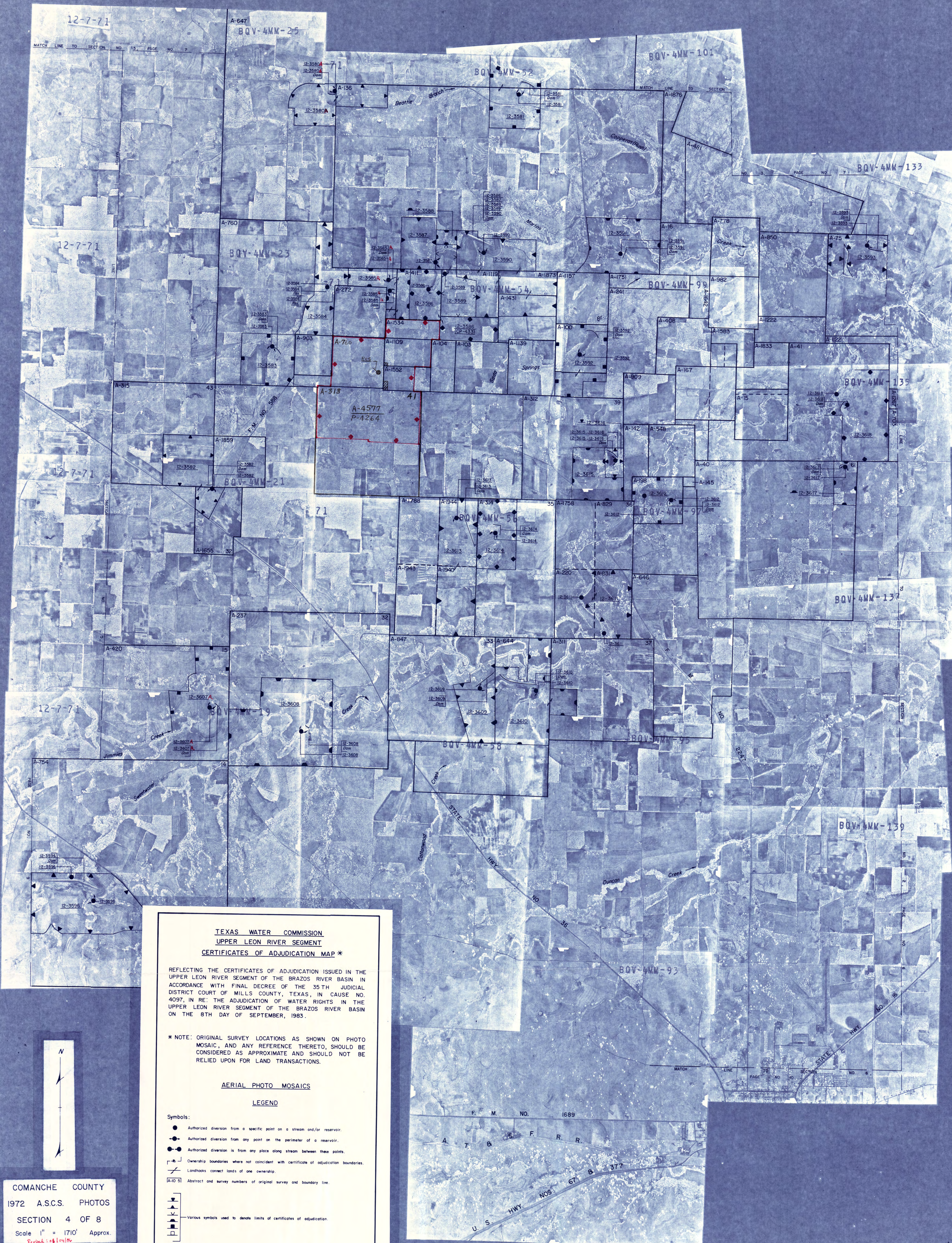

TEXAS WATER COMMISSION
 UPPER LEON RIVER SEGMENT
 CERTIFICATES OF ADJUDICATION MAP *

REFLECTING THE CERTIFICATES OF ADJUDICATION ISSUED IN THE UPPER LEON RIVER SEGMENT OF THE BRAZOS RIVER BASIN IN ACCORDANCE WITH FINAL DECREE OF THE 35TH JUDICIAL DISTRICT COURT OF MILLS COUNTY, TEXAS, IN CAUSE NO. 4097, IN RE: THE ADJUDICATION OF WATER RIGHTS IN THE UPPER LEON RIVER SEGMENT OF THE BRAZOS RIVER BASIN ON THE 8TH DAY OF SEPTEMBER, 1983.

* NOTE: ORIGINAL SURVEY LOCATIONS AS SHOWN ON PHOTO MOSAIC, AND ANY REFERENCE THERETO, SHOULD BE CONSIDERED AS APPROXIMATE AND SHOULD NOT BE RELIED UPON FOR LAND TRANSACTIONS.

AERIAL PHOTO MOSAICS

LEGEND

- Symbols:
- Authorized diversion from a specific point on a stream and/or reservoir.
 - Authorized diversion from any point on the perimeter of a reservoir.
 - Authorized diversion is from any place along stream between these points.
 - Ownership boundaries where not coincident with certificate of adjudication boundaries.
 - Landlocks connect lands of one ownership.
 - (A-10) Abstract and survey numbers of original survey and boundary line.

- ▬ Various symbols used to denote limits of certificates of adjudication.

- Abbreviations:
- 12-3500 Certificate of adjudication number.
 - dam On channel dam authorized by certificate of adjudication.
 - res Off channel reservoir authorized by certificate of adjudication.

COMANCHE COUNTY
 1972 A.S.C.S. PHOTOS
 SECTION 4 OF 8
 Scale 1" = 1710' Approx.
 Revised 12/10/86
 1:58, 28/86
 1 inch

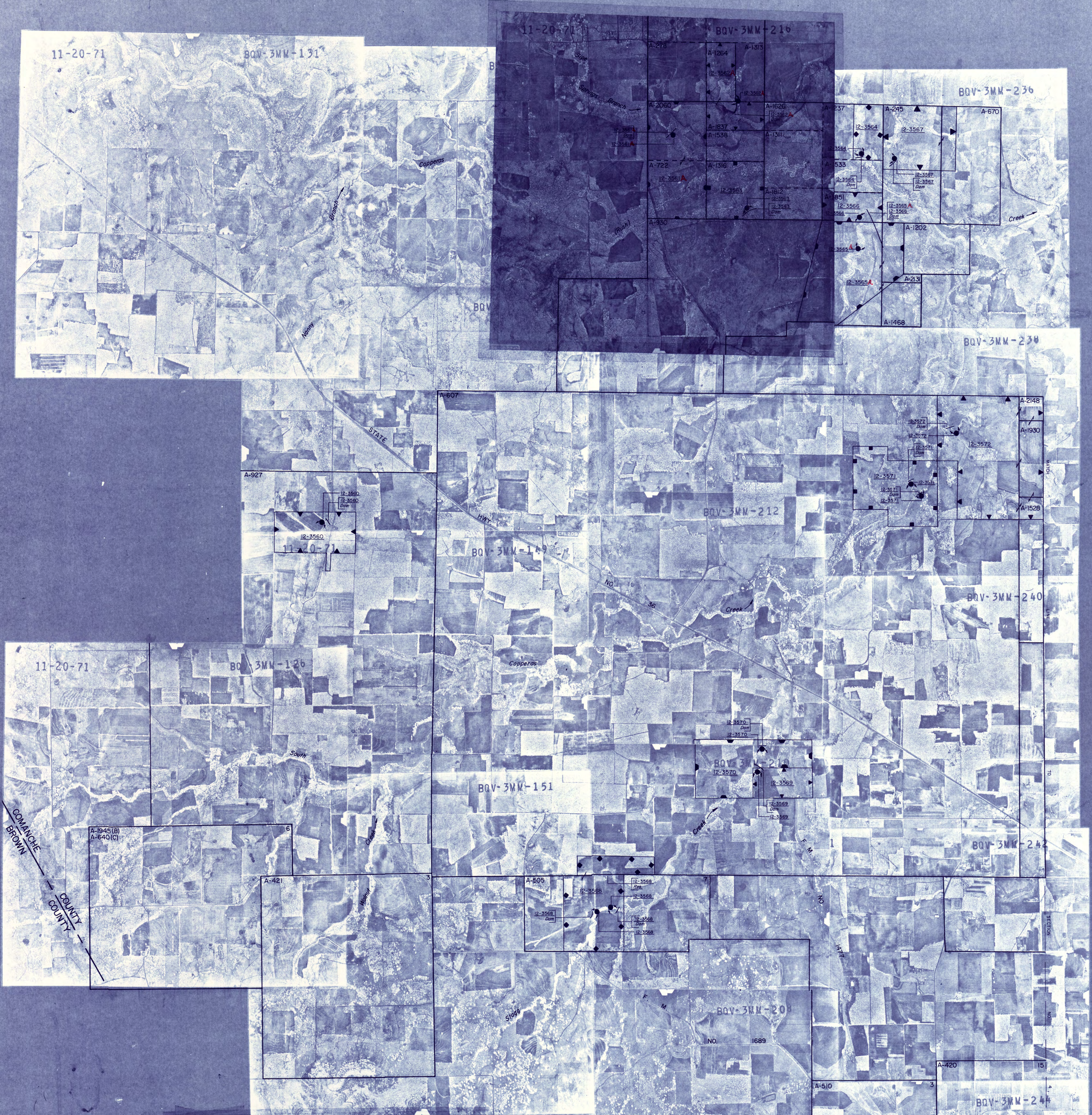

TEXAS WATER COMMISSION
UPPER LEON RIVER SEGMENT
CERTIFICATES OF ADJUDICATION MAP *

REFLECTING THE CERTIFICATES OF ADJUDICATION ISSUED IN THE UPPER LEON RIVER SEGMENT OF THE BRAZOS RIVER BASIN IN ACCORDANCE WITH FINAL DECREE OF THE 35TH JUDICIAL DISTRICT COURT OF MILLS COUNTY, TEXAS, IN CAUSE NO. 4097, IN RE: THE ADJUDICATION OF WATER RIGHTS IN THE UPPER LEON RIVER SEGMENT OF THE BRAZOS RIVER BASIN ON THE 8TH DAY OF SEPTEMBER, 1983.

* NOTE: ORIGINAL SURVEY LOCATIONS AS SHOWN ON PHOTO MOSAIC, AND ANY REFERENCE THERE TO, SHOULD BE CONSIDERED AS APPROXIMATE AND SHOULD NOT BE RELIED UPON FOR LAND TRANSACTIONS.

AERIAL PHOTO MOSAICS
LEGEND

- Symbols:
- Authorized diversion from a specific point on a stream and/or reservoir.
 - Authorized diversion from any point on the perimeter of a reservoir.
 - Authorized diversion is from any place along stream between these points.
 - Ownership boundaries where not coincident with certificate of adjudication boundaries.
 - Landlocks connect lands of one ownership.
 - [A-10] Abstract and survey numbers of original survey and boundary line.
- Various symbols used to denote limits of certificates of adjudication.
- Abbreviations:
- 12-3500 Certificate of adjudication number.
 - dam On channel dam authorized by certificate of adjudication.
 - res Off channel reservoir authorized by certificate of adjudication.

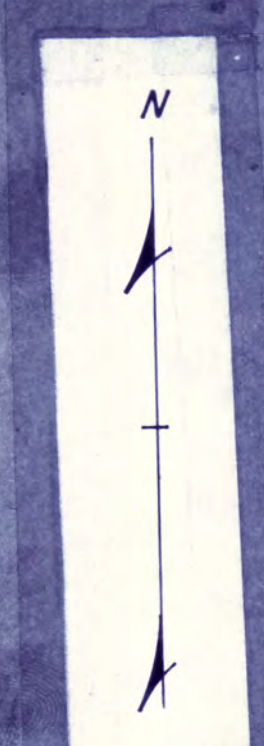

COMANCHE COUNTY
1972 A.S.C.S. PHOTOS
SECTION 5 OF 8
Scale 1" = 1730' Approx.
05/19/86

1 inch

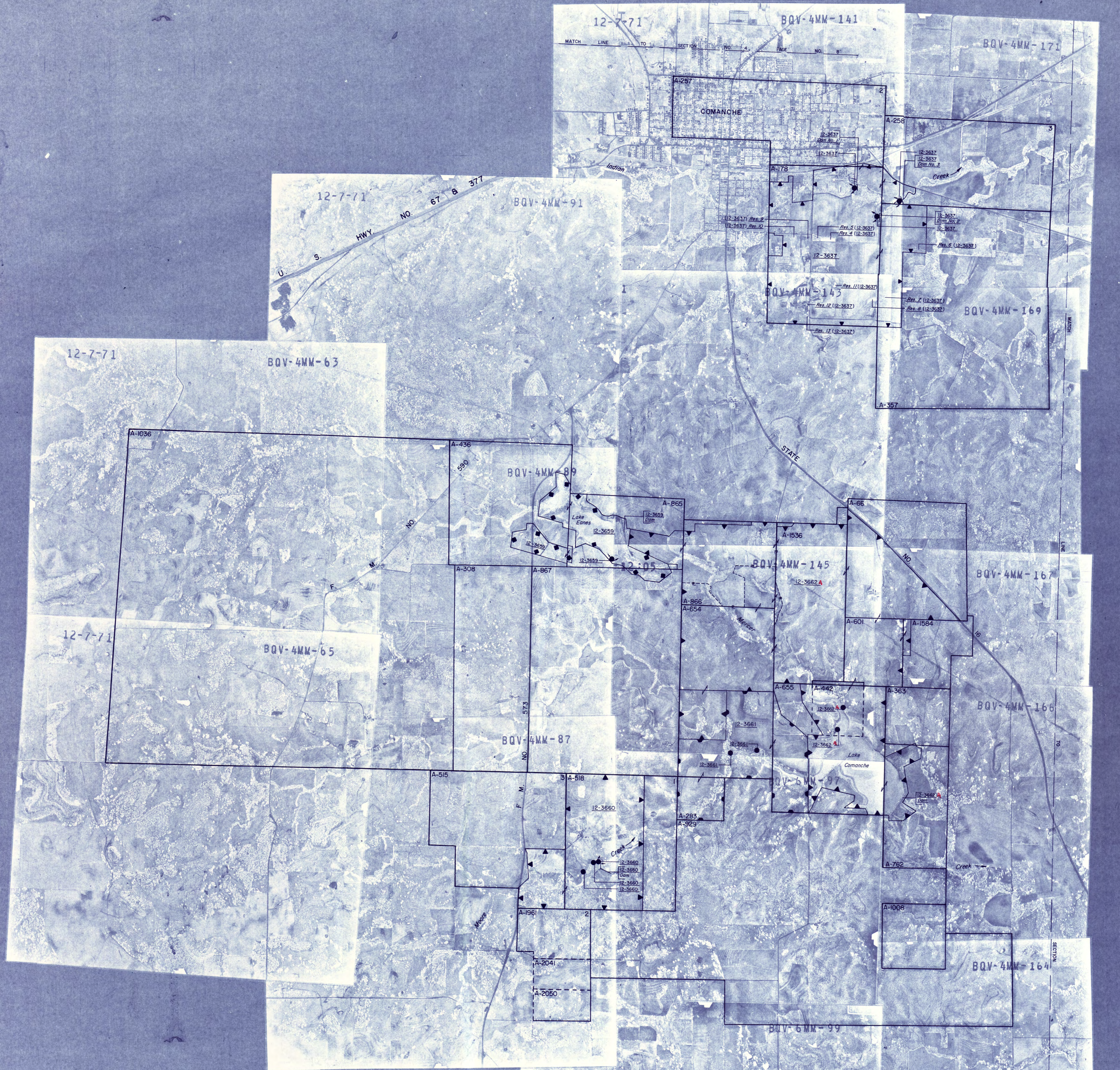

TEXAS WATER COMMISSION
 UPPER LEON RIVER SEGMENT
 CERTIFICATES OF ADJUDICATION MAP *

REFLECTING THE CERTIFICATES OF ADJUDICATION ISSUED IN THE UPPER LEON RIVER SEGMENT OF THE BRAZOS RIVER BASIN IN ACCORDANCE WITH FINAL DECREE OF THE 35TH JUDICIAL DISTRICT COURT OF MILLS COUNTY, TEXAS, IN CAUSE NO. 4097, IN RE: THE ADJUDICATION OF WATER RIGHTS IN THE UPPER LEON RIVER SEGMENT OF THE BRAZOS RIVER BASIN ON THE 8TH DAY OF SEPTEMBER, 1983.

* NOTE: ORIGINAL SURVEY LOCATIONS AS SHOWN ON PHOTO MOSAIC, AND ANY REFERENCE THERETO, SHOULD BE CONSIDERED AS APPROXIMATE AND SHOULD NOT BE RELIED UPON FOR LAND TRANSACTIONS.

AERIAL PHOTO MOSAICS
 LEGEND

- Symbols:
- Authorized diversion from a specific point on a stream and/or reservoir.
 - Authorized diversion from any point on the perimeter of a reservoir.
 - Authorized diversion is from any place along stream between these points.
 - Ownership boundaries where not coincident with certificate of adjudication boundaries.
 - Landowners connect lands of one ownership.
 - [A-10 S] Abstract and survey numbers of original survey and boundary line.
 - ▬ Various symbols used to denote limits of certificates of adjudication.

- Abbreviations:
- 12-3500 Certificate of adjudication number.
 - dam On channel dam authorized by certificate of adjudication.
 - off Off channel reservoir authorized by certificate of adjudication.

COMANCHE COUNTY
 1972 A.S.C.S. PHOTOS
 SECTION 6 OF 8

Scale 1" = 1705' Approx
 UPDATE 18 APR 84

1 inch



TEXAS WATER COMMISSION
UPPER LEON RIVER SEGMENT
CERTIFICATES OF ADJUDICATION MAP *

REFLECTING THE CERTIFICATES OF ADJUDICATION ISSUED IN THE UPPER LEON RIVER SEGMENT OF THE BRAZOS RIVER BASIN IN ACCORDANCE WITH FINAL DECREE OF THE 35TH JUDICIAL DISTRICT COURT OF MILLS COUNTY, TEXAS, IN CAUSE NO. 4097, IN RE: THE ADJUDICATION OF WATER RIGHTS IN THE UPPER LEON RIVER SEGMENT OF THE BRAZOS RIVER BASIN ON THE 8TH DAY OF SEPTEMBER, 1983.

* NOTE: ORIGINAL SURVEY LOCATIONS AS SHOWN ON PHOTO MOSAIC, AND ANY REFERENCE THERETO, SHOULD BE CONSIDERED AS APPROXIMATE AND SHOULD NOT BE RELIED UPON FOR LAND TRANSACTIONS.

AERIAL PHOTO MOSAICS

LEGEND

Symbols:

- Authorized diversion from a specific point on a stream and/or reservoir.
- Authorized diversion from any point on the perimeter of a reservoir.
- Authorized diversion to from any point along stream between these points.
- Certificate boundaries where not coincident with certificate of adjudication boundaries.
- Landmark corner (ends of one corner).
- Abstract and survey numbers of original survey and boundary line.
- ▲ Various symbols used to denote limits of certificates of adjudication.

Abbreviations:

- B-3500 Certificate of adjudication number.
- On channel dam authorized by certificate of adjudication.
- Off channel reservoir authorized by certificate of adjudication.

COMANCHE COUNTY
 1972 ASCS PHOTOS
 SECTION 7 OF 8
 Scale 1" = 1720' Approx
 1 inch



**TEXAS WATER COMMISSION
UPPER LEON RIVER SEGMENT
CERTIFICATES OF ADJUDICATION MAP ***

REFLECTING THE CERTIFICATES OF ADJUDICATION ISSUED IN THE UPPER LEON RIVER SEGMENT OF THE BRAZOS RIVER BASIN IN ACCORDANCE WITH FINAL DECREE OF THE 35TH JUDICIAL DISTRICT COURT OF MILLS COUNTY, TEXAS, IN CAUSE NO. 4097, IN RE: THE ADJUDICATION OF WATER RIGHTS IN THE UPPER LEON RIVER SEGMENT OF THE BRAZOS RIVER BASIN ON THE 8TH DAY OF SEPTEMBER, 1983.

* NOTE: ORIGINAL SURVEY LOCATIONS AS SHOWN ON PHOTO MOSAIC, AND ANY REFERENCE THERETO, SHOULD BE CONSIDERED AS APPROXIMATE AND SHOULD NOT BE RELIED UPON FOR LAND TRANSACTIONS.

AERIAL PHOTO MOSAICS

LEGEND

Symbols:

- Authorized diversion from a specific point on a stream and/or reservoir.
- Authorized diversion from any point on the perimeter of a reservoir.
- Authorized diversion from any place along stream between these points.
- Ownership boundaries where not coincident with certificate of adjudication boundaries.
- Landowners connect lands of one ownership.
- Abstract and survey numbers of original survey and boundary line.

Abbreviations:

- 2-3500 Certificate of adjudication number.
- On channel dam authorized by certificate of adjudication.
- Off channel reservoir authorized by certificate of adjudication.

COMANCHE COUNTY
1972 ASCS. PHOTOS
SECTION 8 OF 8
Scale 1" = 1730' Approx

TEXAS WATER COMMISSION
UPPER LEON RIVER SEGMENT
CERTIFICATES OF ADJUDICATION MAP *

REFLECTING THE CERTIFICATES OF ADJUDICATION ISSUED IN THE UPPER LEON RIVER SEGMENT OF THE BRAZOS RIVER BASIN IN ACCORDANCE WITH FINAL DECREE OF THE 35TH JUDICIAL DISTRICT COURT OF MILLS COUNTY, TEXAS, IN CAUSE NO. 4097, IN RE: THE ADJUDICATION OF WATER RIGHTS IN THE UPPER LEON RIVER SEGMENT OF THE BRAZOS RIVER BASIN ON THE 8TH DAY OF SEPTEMBER, 1983.

* NOTE: ORIGINAL SURVEY LOCATIONS AS SHOWN ON PHOTO MOSAIC, AND ANY REFERENCE THERETO, SHOULD BE CONSIDERED AS APPROXIMATE AND SHOULD NOT BE RELIED UPON FOR LAND TRANSACTIONS.

AERIAL PHOTO MOSAICS

LEGEND

Symbols:

- Authorized diversion from a specific point on a stream and/or reservoir.
- Authorized diversion from any point on the perimeter of a reservoir.
- Authorized diversion is from any place along stream between these points.
- Ownership boundaries where not coincident with certificate of adjudication boundaries. Landbooks connect lands of one ownership.
- [A-105] Abstract and survey numbers of original survey and boundary line.

- ▲ Various symbols used to denote limits of certificates of adjudication.

Abbreviations:

- [12-3500] Certificate of adjudication number.
- [Dam] On channel dam authorized by certificate of adjudication.
- [Res] Off channel reservoir authorized by certificate of adjudication.



ERATH COUNTY
1966 A.S.C. PHOTOS
SECTION 1 OF 3
Scale 1" = 1695' Approx

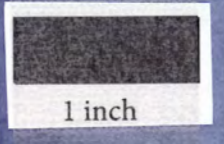

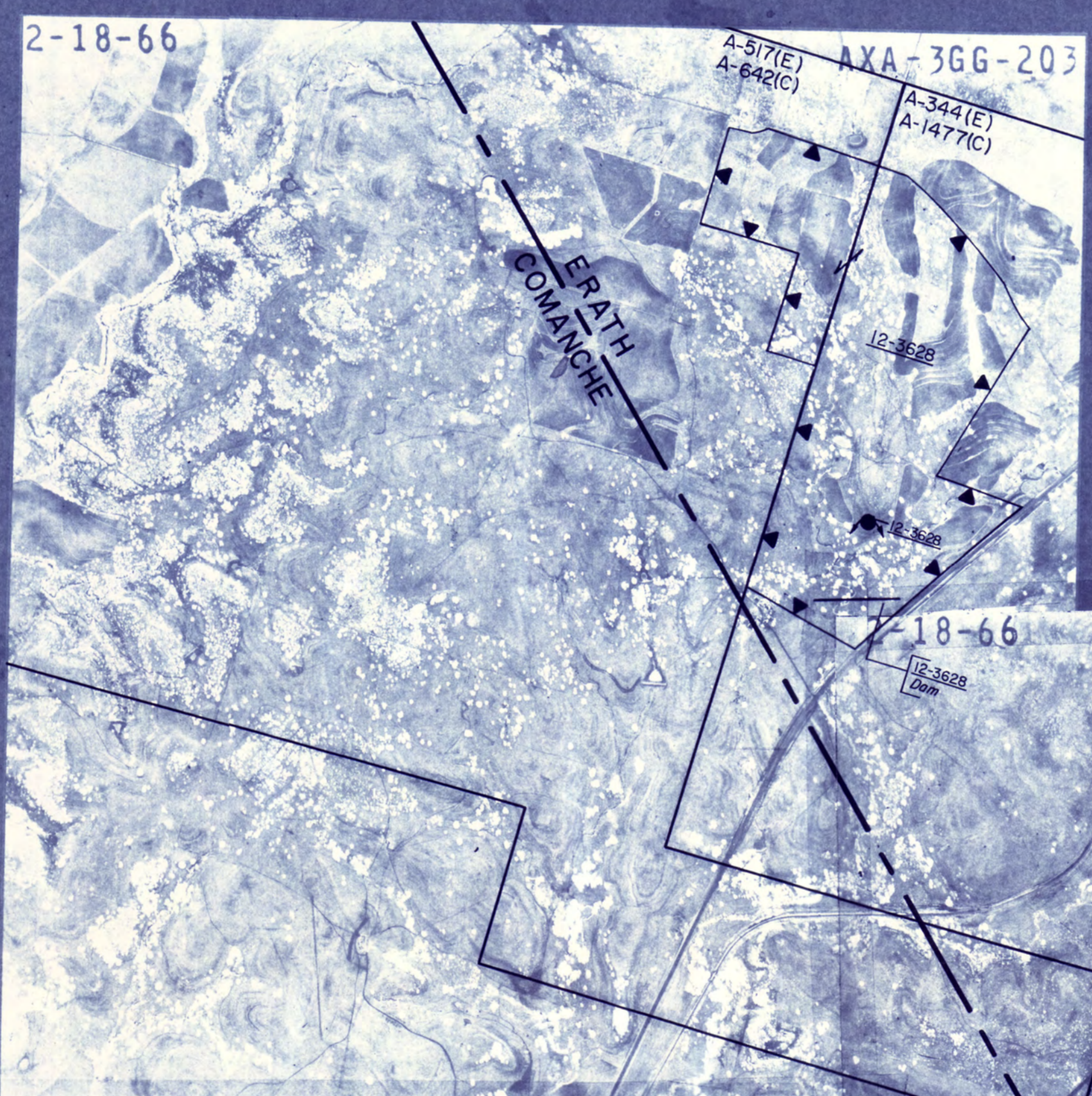
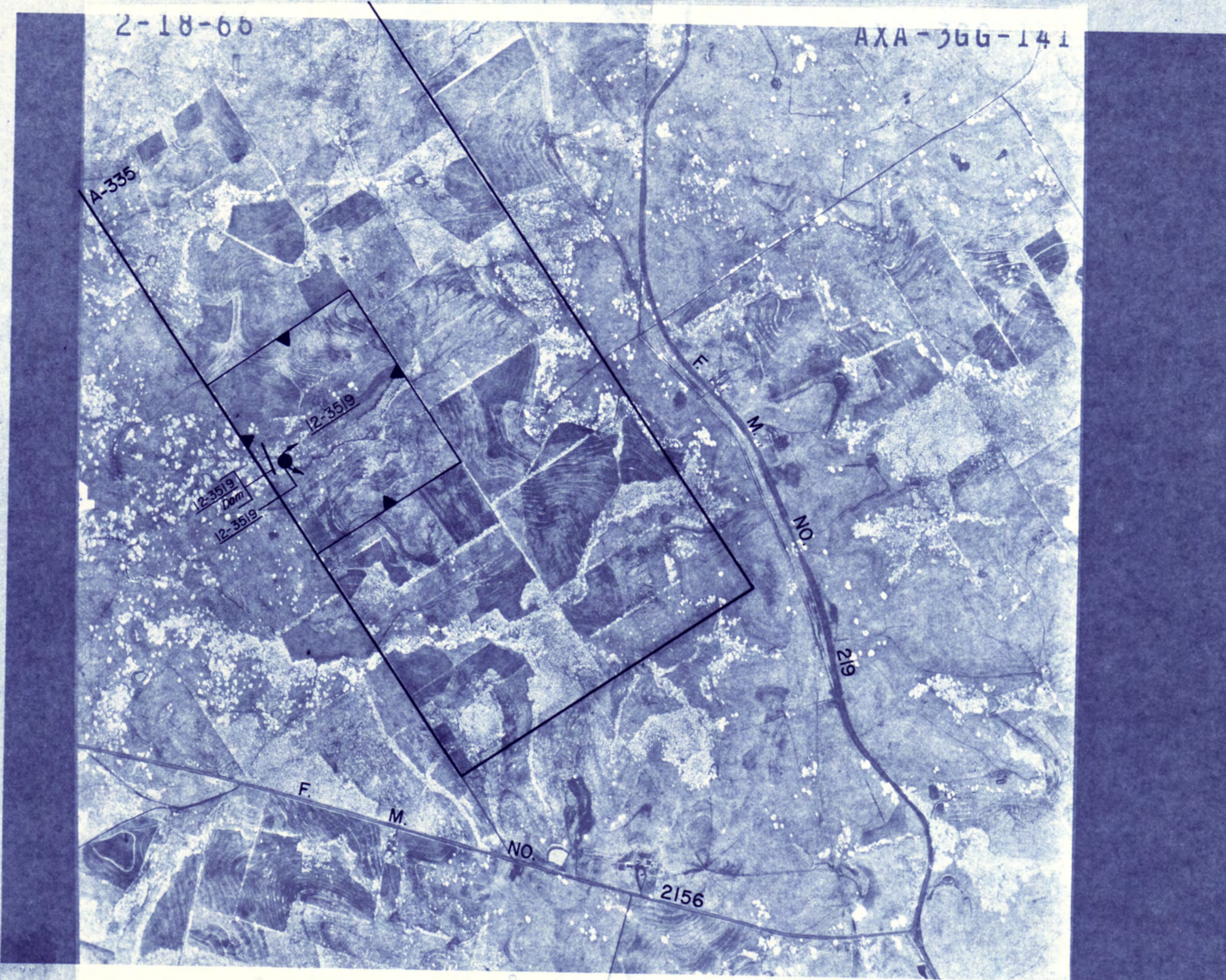

ERATH COUNTY
1966 A.S.C.S PHOTOS
SECTION 2 OF 3
Scale 1" = 1660' Approx

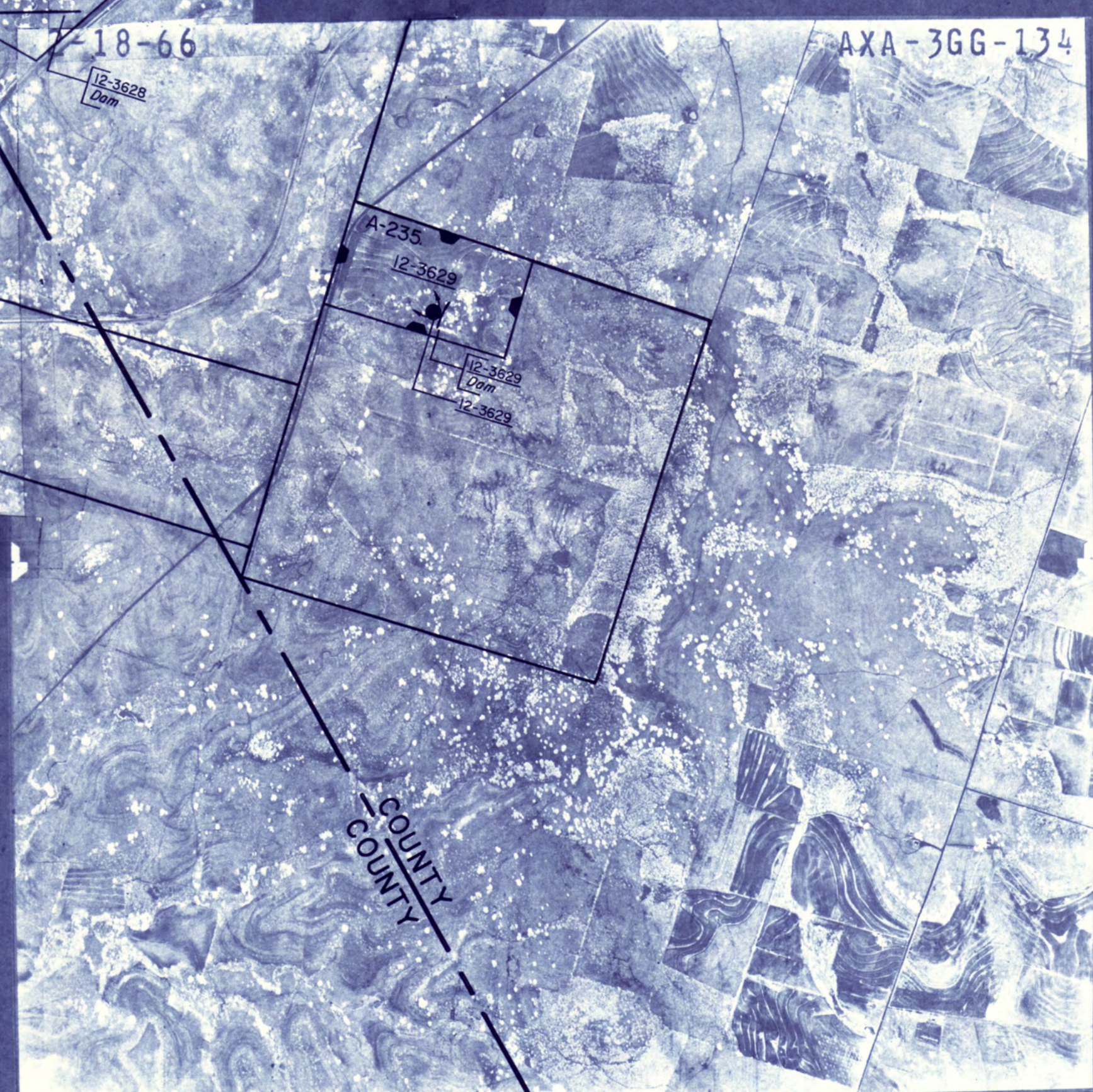
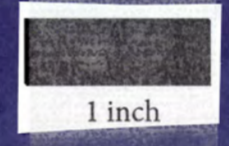

ERATH COUNTY
(1966 A.S.C.S PHOTOS)
SECTION 3 OF 3
Scale 1" = 1705' Approx

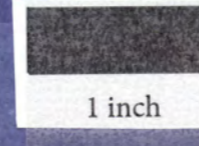

TEXAS WATER COMMISSION
UPPER LEON RIVER SEGMENT
CERTIFICATES OF ADJUDICATION MAP *

REFLECTING THE CERTIFICATES OF ADJUDICATION ISSUED IN THE UPPER LEON RIVER SEGMENT OF THE BRAZOS RIVER BASIN IN ACCORDANCE WITH FINAL DECREE OF THE 35TH JUDICIAL DISTRICT COURT OF MILLS COUNTY, TEXAS, IN CAUSE NO. 4097, IN RE: THE ADJUDICATION OF WATER RIGHTS IN THE UPPER LEON RIVER SEGMENT OF THE BRAZOS RIVER BASIN ON THE 8TH DAY OF SEPTEMBER, 1983.

* NOTE: ORIGINAL SURVEY LOCATIONS AS SHOWN ON PHOTO MOSAIC, AND ANY REFERENCE THERETO, SHOULD BE CONSIDERED AS APPROXIMATE AND SHOULD NOT BE RELIED UPON FOR LAND TRANSACTIONS.

AERIAL PHOTO MOSAICS

LEGEND

- Symbols:
- Authorized diversion from a specific point on a stream and/or reservoir.
 - Authorized diversion from any point on the perimeter of a reservoir.
 - Authorized diversion is from any place along stream between these points.
 - |— Ownership boundaries where not coincident with certificate of adjudication boundaries.
 - |— Landlocks connect lands of one ownership.
 - [A-10 S] Abstract and survey numbers of original survey and boundary line.
 - ▼ Various symbols used to denote limits of certificates of adjudication.
- Abbreviations:
- 12-3500 Certificate of adjudication number.
 - dam On channel dam authorized by certificate of adjudication.
 - res Off channel reservoir authorized by certificate of adjudication.

41